

REPLACEMENT PARTS			
DESCRIPTION	NEW CODE	OLD CODE	PRICE
Ash pan plug	1.5.3.NPT		15.00
Ash pan	1.5.2.N		50.00
Top louver fin (black)	10.1.NPR	A959	10.00
Top louver fin (gold)	10.11.NPR		30.00
Top louver fin (pewter)	10.21.NPR		30.00
Top louver hardware assembly	99.10.04.N		10.00
Nut 1/4-20 Hex	14.3.52	R1415	N/A
Louver rod	14.9.2	R6417	5.00
Retention spring for louvers	14.5.3	R6309	1.00
Spacer 1/4" X 1 3/8"	14.8.5	R6149	1.00
Bottom louver fin (black)	10.2.NP	A959-1	10.00
Bottom louver fin (gold)	10.12.NP		30.00
Bottom louver fin (pewter)	10.22.NP		30.00
Bottom louver top fin (black)	10.6.N		10.00
Bottom louver top fin (gold)	10.16.N		30.00
Bottom louver top fin (pewter)	10.26.N		30.00
Bottom louver hardware assembly	99.10.05.N		15.00
Bolt 1/4" x 3 1/4" NC plain	14.1.64	R1228	N/A
Nut 1/4-20 Hex	14.3.52	R1415	N/A
Nut 1/4-20 stover	14.3.54	R1416	N/A
Spacer 1/4" X 1 3/8"	14.8.5	R6149	1.00
Lower louver magnet stop	10.3.NP		4.00
Magnet bracket assembly	1.10.3.NP		10.00
Door gasket (c/w silicone)	FDGRK1		25.00
Door glass	14.7.3	R6246-AA1249	300.00
Door frame	1.9.3.NR	A1212W	N/A
Door hinge assembly	1.9.6.NR	A1211-A1242W	20.00
Door channel top (black)	98.09.01.N	A1232TG	40.00
Door channel bottom (black)	98.09.02.N	A1232BG	40.00
Window channel gasket	14.10.1	R7000	10.00
Hinge pin	14.17.15	R6410	10.00
Door closure assembly	99.09.01.N	A1214-3	20.00
Door closer hooks assembly	1.9.1.NR		P/A
Door closer hooks	9.1.NR	A1210	P/A
Split pin 5/32 x 11/16	14.4.6	R1850	P/A
Door closer rod	9.3.NR	A1214-1	P/A
Door handle grip (wood)	14.6.1	R6012	5.00
Refractory complete set	99.11.01.N		160.00
Side refractory (right)	11.1.N	A1240-2, R4201	45.00
Side refractory (left)	11.2.N	A1240-1, R4202	45.00
Back refractory	11.3.N	A1240-6, R4203	35.00
Front refractory (right)	11.4.N	A1240-3, R4204	15.00
Front refractory (left)	11.5.N	A1240-4, R4205	15.00
Top refractory	11.6.N	A1240-5, R4207	35.00
Bottom refractory	11.7.N	R4208	40.00
Primary air screen	7.21.N	AA1222	20.00
Draft control gasket	7.2.DNP	A989	4.00
Draft control	1.7.1.N	A1204	130.00
Inner shield	2.1.N	A1215W	N/A
Draft control lever	4.1.DNP	A953W	10.00
Draft control knob	14.6.2	R6000	4.00
Spring	14.5.6		2.00
Chain and pendant assembly	99.06.01.N		10.00
Chain # 10	14.17.3	R6110	P/A
Detachable pendant	14.17.4	R6121	P/A
Secondary air tube (centre)	7.8.N	A1226	55.00
Secondary air tube (front)	7.9.N	A1226-1	55.00
Secondary air tube (rear)	7.10.N	A1226-2	55.00
Face stand off assembly	1.6.1.N	A1223W	30.00
Stand off top	6.13.N	A1223-5W	50.00
Terminal block assembly	99.12.01.N		25.00
Terminal block	1.12.1.DNPR	AA1088W	P/A
Terminal block cover	12.2.DNPR	AA1089	P/A
NOT AVAILABLE			N/A
PART OF ASSEMBLY			P/A

99.010.04.N  
TOP LOUVER  
HARWARE  
ASSEMBLY

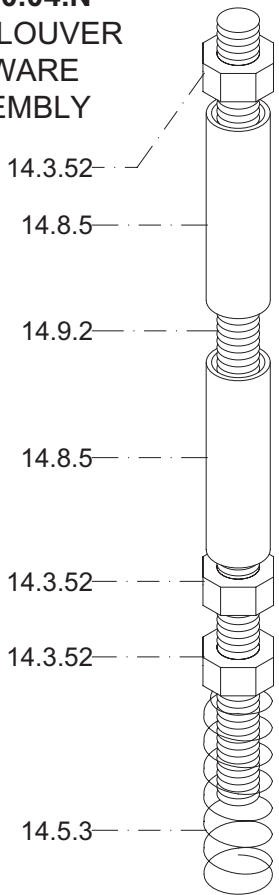

99.10.05.N  
BOTTOM  
LOUVER  
HARDWARE  
ASSEMBLY

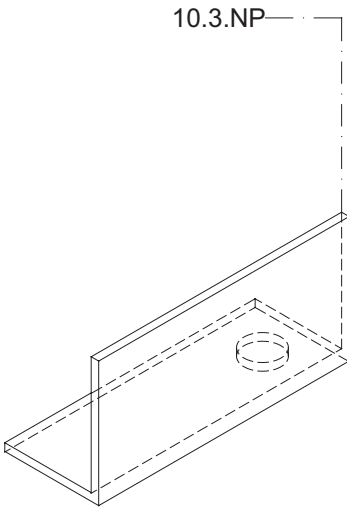
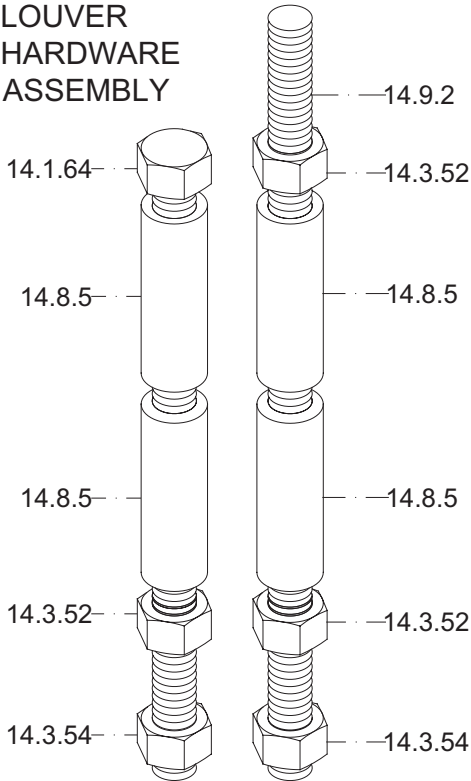

REPLACEMENT PARTS

DESCRIPTION	NEW CODE	OLD CODE	PRICE
Ash pan plug	1.5.3.NPT		15.00
Ash pan	1.5.2.N		50.00
Top louver fin (black)	10.1.NPR	A959	10.00
Top louver fin (gold)	10.11.NPR		30.00
Top louver fin (pewter)	10.21.NPR		30.00
Top louver hardware assembly	99.10.04.N		10.00
Nut 1/4-20 Hex	14.3.52	R1415	N/A
Louver rod	14.9.2	R6417	5.00
Retention spring for louvers	14.5.3	R6309	1.00
Spacer 1/4" X 1 3/8"	14.8.5	R6149	1.00
Bottom louver fin (black)	10.2.NP	A959-1	10.00
Bottom louver fin (gold)	10.12.NP		30.00
Bottom louver fin (pewter)	10.22.NP		30.00
Bottom louver top fin (black)	10.6.N		10.00
Bottom louver top fin (gold)	10.16.N		30.00
Bottom louver top fin (pewter)	10.26.N		30.00
Bottom louver hardware assembly	99.10.05.N		15.00
Bolt 1/4" x 3 1/4" NC plain	14.1.64	R1228	N/A
Nut 1/4-20 Hex	14.3.52	R1415	N/A
Nut 1/4-20 stover	14.3.54	R1416	N/A
Spacer 1/4" X 1 3/8"	14.8.5	R6149	1.00
Lower louver magnet stop	10.3.NP		4.00
Magnet bracket assembly	1.10.3.NP		10.00
Door gasket (c/w silicone)	FDGRK1		25.00
Door glass	14.7.3	R6246-AA1249	300.00
Door frame	1.9.3.NR	A1212W	N/A
Door hinge assembly	1.9.6.NR	A1211-A1242W	20.00
Door channel top (black)	98.09.01.N	A1232TG	40.00
Door channel bottom (black)	98.09.02.N	A1232BG	40.00
Window channel gasket	14.10.1	R7000	10.00
Hinge pin	14.17.15	R6410	10.00
Door closure assembly	99.09.01.N	A1214-3	20.00
Door closer hooks assembly	1.9.1.NR		P/A
Door closer hooks	9.1.NR	A1210	P/A
Split pin 5/32 x 11/16	14.4.6	R1850	P/A
Door closer rod	9.3.NR	A1214-1	P/A
Door handle grip (wood)	14.6.1	R6012	5.00
Refractory complete set	99.11.01.N		160.00
Side refractory (right)	11.1.N	A1240-2, R4201	45.00
Side refractory (left)	11.2.N	A1240-1, R4202	45.00
Back refractory	11.3.N	A1240-6, R4203	35.00
Front refractory (right)	11.4.N	A1240-3, R4204	15.00
Front refractory (left)	11.5.N	A1240-4, R4205	15.00
Top refractory	11.6.N	A1240-5, R4207	35.00
Bottom refractory	11.7.N	R4208	40.00
Primary air screen	7.21.N	AA1222	20.00
Draft control gasket	7.2.DNP	A989	4.00
Draft control	1.7.1.N	A1204	130.00
Inner shield	2.1.N	A1215W	N/A
Draft control lever	4.1.DNP	A953W	10.00
Draft control knob	14.6.2	R6000	4.00
Spring	14.5.6		2.00
Chain and pendant assembly	99.06.01.N		10.00
Chain # 10	14.17.3	R6110	P/A
Detachable pendant	14.17.4	R6121	P/A
Secondary air tube (centre)	7.8.N	A1226	55.00
Secondary air tube (front)	7.9.N	A1226-1	55.00
Secondary air tube (rear)	7.10.N	A1226-2	55.00
Face stand off assembly	1.6.1.N	A1223W	30.00
Stand off top	6.13.N	A1223-5W	50.00
Terminal block assembly	99.12.01.N		25.00
Terminal block	1.12.1.DNPR	AA1088W	P/A
Terminal block cover	12.2.DNPR	AA1089	P/A

NOT AVAILABLE  
PART OF ASSEMBLY

N/A  
P/A

99.11.01.N  
REFRACTORY  
COMPLETE SET

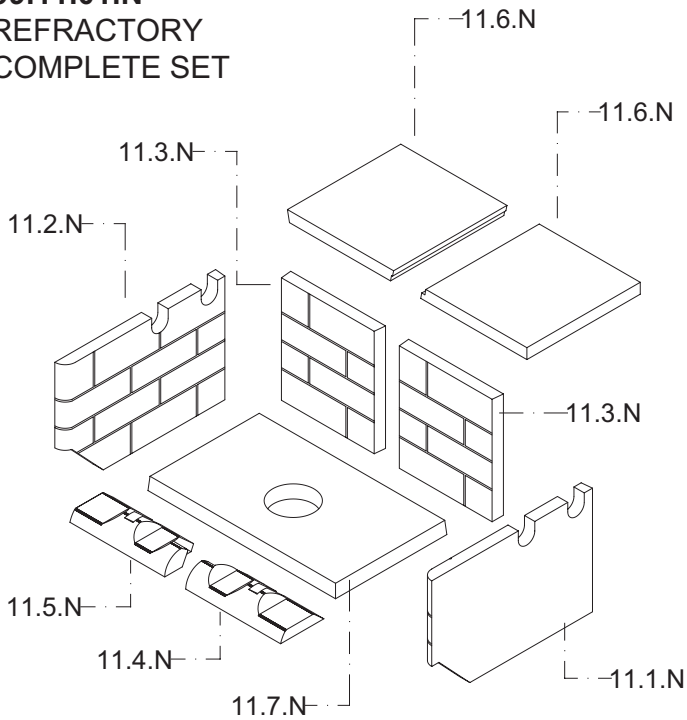

99.09.01.N  
DOOR CLOSURE  
ASSEMBLY

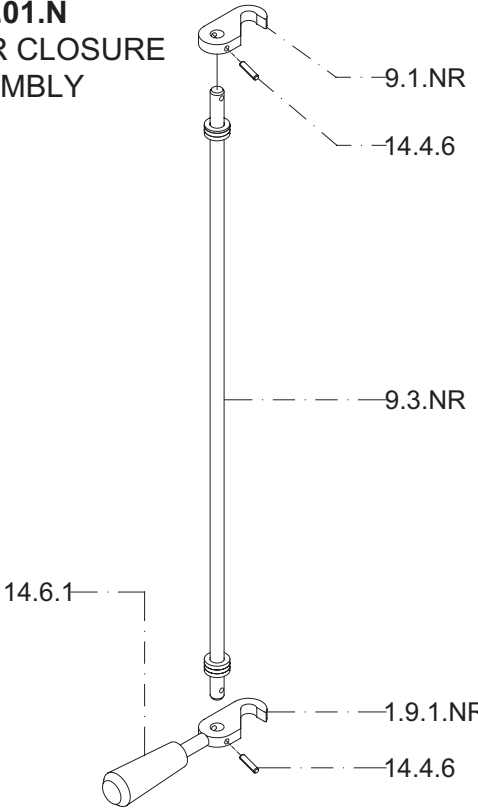

99.06.01.N  
CHAIN & PENDANT  
ASSEMBLY

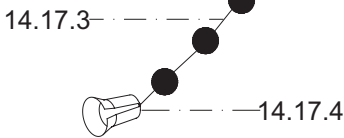

99.12.01.N  
TERMINAL BLOCK  
ASSEMBLY

